

12volt NorthStar Pumps



The NorthStar® NSQ Series™ 12V On-Demand Diaphragm Pump is a premium-quality on-demand diaphragm pump that upgrades your sprayer with innovative components and engineering for superior spot or broadcast spraying performance. 100% continuous duty rating with no cool down period required.

Ref.No.		Self-priming	Amps	Max.Pres	Max flow	List Price	Code
NS2681042	Northstar NSQ On-Demand Pump Includes two 3/8in. hose barb fittings	1.2m Lift	4	40 psi	3.7 L/min	\$ 100 +GST	C
NS2682272	Northstar NQS On-Demand Pump includes 3/8in. and 1/2in. hose barbs and 1/2in. male NPT fitting	3.0m Lift	8	70 psi	8.3 L/min	\$ 175 +GST	C
NS2683062	Northstar NSQ On-Demand Pump includes 1/2in. hose barb and 1/2in. male NPT fitting	3.65m Lift	13	60 psi	11.36 L/min	\$ 225 +GST	C
NS2684062	Northstar NSQ On-Demand Pump includes 1/2in. hose barb and 1/2in. male NPT fitting	3.65m Lift	13	60 psi	15.1 L/min	\$ 250 +GST	C
NS2687062	Northstar NSQ On-Demand Pump Includes 3/4in. hose barbs and 1/2in. male NPT fitting	3.65m Lift	23	60 psi	26.5 L/min	\$ 425 +GST	C



4+ Code B
8+ Code A



NorthStar® NSQ Series™ 12V On-Demand Pump Come in a Display Box with Manual

24volt NorthStar Pumps

This high-end NorthStar® NSQ Series™ 24V pump upgrades your sprayer with innovative components and engineering for superior spot or broadcast spraying performance and quick-connect convenience. 100% continuous duty rating with no cool down period required. 24V pump has low amp draw and requires two 12V DC batteries connected in series.



Ref.No.		Self-priming	Amps	Max.Pres	Max flow	List Price	Code
NS2685564	Northstar NSQ On-Demand Pump includes 3/4in. hose barb and 1/2in. male NPT fitting	3.65m Lift	9	60 psi	20.8 L/min	\$ 285 +GST	C
NS2687064	Northstar NSQ On-Demand Pump Includes 3/4in. hose barbs and 1/2in. male NPT fitting	3.65m Lift	12	60 psi	26.5 L/min	\$ 450 +GST	C

Pump Parts and Fittings



Ref.No.		List Price
NS787208	Hose/Pipe Fitting 3/8in. Hose Barb x 3/4in. Quick Connect	\$ 4.95 +GST
NS787212	Hose/Pipe Fitting 3/8in. Hose Barb x 3/4in. Quick Connect Elbow	\$ 5.40 +GST
NS787209	Hose/Pipe Fitting 1/2in. Hose Barb x 3/4in. Quick Connect	\$ 5.45 +GST
NS787213	Hose/Pipe Fitting 1/2in. Hose Barb x 3/4in. Quick Connect Elbow	\$ 5.90 +GST
NS787210	Hose/Pipe Fitting 3/4in. Hose Barb x 3/4in. Quick Connect	\$ 5.95 +GST
NS787214	Hose/Pipe Fitting 3/4in. Hose Barb x 3/4in. Quick Connect Elbow	\$ 6.40 +GST
NS787211	Hose/Pipe Fitting — 1/2in. Male NPT x 3/4in. Quick Connect	\$ 6.15 +GST
NS787216	Hose/Pipe Fitting — 3/8in. Hose Barb x 3/4in. Quick Connect, 1/4in. Female NPT	\$ 7.40 +GST



NothStar Pump Parts

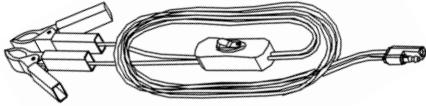

Remote Switch and Loom
Part Number - NS777493



Broadcast Nozzle
Part Number - NS779377

Broadcast Lance Kit
Part Number - NS268852

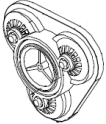
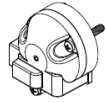

Ref.No.		List Price
NS786953	Pressure Switch Assembly For 2682271, 2682272 and 786226 (8.3 LPM)	\$ 25.00 +GST
NS788689	Pressure Switch Assembly For 2684062 and 2687062 (15.1 and 26.5 LPM)	\$ 25.00 +GST
NS778279	Valve Assembly For 2682271, 2682272 and 786226 (8.3 LPM)	\$ 25.00 +GST
NS788015	Valve Plate Assembly For 2684062 and 2687062 (15.1 and 26.5 LPM)	\$ 35.00 +GST

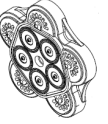
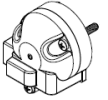

Geoline Pump Parts

Ref.No.		List Price
GEOK00110002	Valve Kit (PAK Pump)	\$ 59.00 +GST
GEOK00110000	Pressure Switch (PAK Pump)	\$ 28.60 +GST

Fits Shurflo 8000 Series Pumps

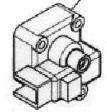
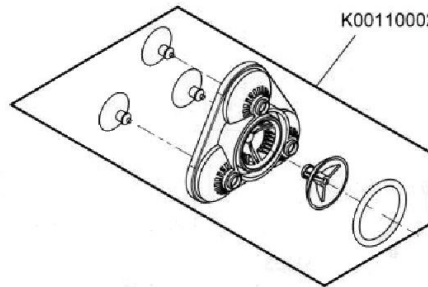

Shurflo Fittings



Ref.No.		List Price
SH-234-2916	Shurflo 1/2" Hex Nut / Straight Tail 10mm	\$ 4.95 +GST
SH-234-3916	Shurflo 1/2" Hex Nut / Elbow Tail 10mm	\$ 4.95 +GST
SH-234-2926	Shurflo 1/2" Hex Nut / Straight Tail 13mm	\$ 4.95 +GST
SH-234-3926	Shurflo 1/2" Hex Nut / Elbow Tail 13mm	\$ 4.95 +GST



Hypro Pumps & Parts



Ref.No.	Model	Max.Pres	Max flow	List Price
AF4101C	Hypro 4101C Roller Pump (4 Roller / 5/8" Shaft)	150 psi	27.3 L/min	\$ 395
AF6500C	Hypro 6500C Roller Pump (6 Roller / 5/8" Shaft)	300 psi	36.7 L/min	\$ 499
AF7560C	Hypro 7560C Roller Pump (8 Roller / 15/16" Shaft)	300 psi	45.4 L/min	\$ 549
AF5210C	Hypro 5210C Piston Pump (1" O.D. Solid Shaft)	400 psi	35 L/min	\$ 1,500
AF13210006	1-3/8" (6 Spline) Quick Release Coupling to 5/8" Pump ID			\$ 100.00
AF13230072	1-3/8" (6 Spline) Quick Release Coupling to 15/16" Pump ID			\$ 135.00
AF13200016	5/8" x 5/8" Adaptor			\$ 85.00

Hypro 6500C Parts

Ref.No.	Type	List Price
AF20000010	Ball Bearing	\$ 22.70
AF21070002	Oil Seal	\$ 23.60
AF17200008	O Ring End Plate	\$ 4.65
AF10050004	Super Roller	\$ 11.50

Hypro 7560C Parts

Ref.No.	Type	List Price
AF20080001	Ball Bearing	\$ 33.80
AF21120003	Oil Seal	\$ 37.40
AF17200014	O Ring End Plate	\$ 6.90
AF10050004	Super Roller	\$ 11.50

Hypro 5210C Parts

Ref.No.	Type	List Price
AF34300037	Leather Cup Kit	\$ 97.90
AF34300189	Rubber Cup Kit	\$ 155.50
AF14400005	Piston Guide	\$ 19.50
AF34000038	Valve Assembly	\$ 57.50

Hypro Centrifugal Pumps

Ref.No.	Model	Max.Pres	Max flow	List Price
AF9303C-HM1C	Centrifugal Pump with Hyd Motor	130 psi	431 L/min	\$ 2,120
AF9203C	Centrifugal Pump	180 psi	530 L/min	\$ 975
AF1538	Centrifugal Pump, Fits 5.5hp Honda with 5/8" UNF Threaded Pump Shaft	75 psi	415 L/min	\$ 1340



Hypro Centrifugal Parts

Ref.No.	Type	List Price
AF34300332	Seal Kit	\$ 123.50
AF04019100P	Nylon Impeller	\$ 104.50

Udor Kappa Series Diaphragm Pump

The Kappa/Delta Pumps are made in Italy

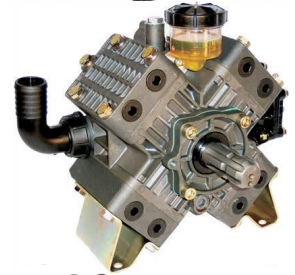

High Pressure Pumps (580psi)				
Ref.No.	Description	Inlet Hose Size	List Price	Code
Udor 840600	Kappa 33 1C (32.6 LPM)	1"	\$ 765.00 +GST	C
Udor 841100	Kappa 43 1C (45.7 LPM)	1 1/4"	\$ 815.00 +GST	C
Udor 841600	Kappa 53 1C (54.8 LPM)	1 1/4"	\$ 865.00 +GST	C
Udor 813800	Delta 75 1C (76.0 LPM)	1 1/4"	\$ 1,150.00 +GST	C
Udor 806900	Delta 100 1C (97.0 LPM)	1 1/2"	\$ 1,450.00 +GST	C
Udor 816900	Kappa 151 TS 2C (154.3 LPM)	1 1/2"	\$ 2,500.00 +GST	C

High Pressure Pumps with Female Kit (580psi)				
Ref.No.	Description	Inlet Hose Size	List Price	Code
Udor 840600FM	Kappa 33 (32.6 LPM) Female Kit	1"	\$ 925.00 +GST	C
Udor 841100FM	Kappa 43 (45.7 LPM) Female Kit	1 1/4"	\$ 975.00 +GST	C
Udor 841600FM	Kappa 53 (54.8 LPM) Female Kit	1 1/4"	\$ 1,025.00 +GST	C

Remote Mount



Ref.No.	Description	List Price
Udor 601093	DL Control unit (Pump Mount)	\$175 +GST
Udor 601093B	DL Control unit (Remote Mount)	\$210 +GST

Ref.No.	Description	List Price
Udor 601045	DS Control unit (Pump Mount)	\$185 +GST
Udor 601045B	DS Control unit (Remote Mount)	\$220 +GST



Low Pressure Pumps (290psi)					
Ref.No.	Description	Inlet Hose Size	Outlet	List Price	Code
Udor 844200FM	Iota 20 Pump with Female Kit (19 LPM) (Single Outlet Control Unit)	1"	10mm	\$ 740.00 +GST	C
Udor 8442001C	Iota 20 Pump with Male 1 3/8" Shaft (19 LPM) (Single Outlet Control Unit with Remote Kit)	1 1/4"	10mm	\$ 830.00 +GST	C
Udor 845100FM	Zeta 70 Pump with Female Kit (70.5 LPM) (No Control unit Fitted)	1 1/4"	3/4"	\$ 910.00 +GST	C

Udor Zeta Series Diaphragm Pumps

UDOR Zeta Series Pumps Have Plasticized Aluminum Heads And Glass Filled Nylon Manifolds. Control Units Not Included.

Max. Pump Speed - 540 RPM.



Low Pressure Pumps (290psi)					
Ref.No.	Description	Inlet Hose Size	Outlet Hose Size	List Price	Code
Udor 845100	Zeta 70 1C (70.5 LPM)	1 1/4"	3/4"	\$ 750.00 +GST	C
Udor 846800	Zeta 120 1C (116 LPM)	1 1/2"	3/4"	\$ 1,200.00 +GST	C
Udor 844500	Zeta 170 1C (170 LPM)	1 1/2"	1"	\$ 1,850.00 +GST	C
Udor 849800	Zeta 260 TS 2C (256 LPM)	2"	1 1/2"	\$ 2,500.00 +GST	C

Zeta 120



Zeta 170



Zeta 260



Udor Pumps with Gearbox

Sold without Oil for the Gearbox (Needs 80w90)



Ref.No.	Shaft	Max L/min	Max.Pres	HP / kW	Control	List Price
UDOR 19-GB-5/8	5/8"	19	290 psi	0.8 / 0.6	DI/1	\$ 820 +GST
UDOR 19-GB-3/4	3/4"	19	290 psi	0.8 / 0.6	DI/1	\$ 820 +GST
UDOR 25-GB-5/8	5/8"	29.5	435 psi	1.8 / 1.3	DL/2	\$ 1,040 +GST
UDOR 25-GB-3/4	3/4"	29.5	435 psi	1.8 / 1.3	DL/2	\$ 1,040 +GST
UDOR 40P-GB	3/4"	44	290 psi	2.1 / 1.5	DL/2	\$ 1,690 +GST
UDOR 33-GB	3/4"	32.6	580 psi	3.0 / 2.2	DL/2	\$ 1,300 +GST
UDOR 43-GB	3/4"	45.7	580 psi	4.3 / 3.2	DL/2	\$ 1,350 +GST
UDOR 53-GB	3/4"	54.8	580 psi	5.2 / 3.8	DL/2	\$ 1,400 +GST
UDOR 75-GB	1"	76	580 psi	7.7 / 5.7	DL/2	\$ 1,940 +GST
UDOR 120-GB	3/4"	116	290 psi	5.7 / 4.2	Option	\$ 1,985 +GST



Udor Pumps with GR or VA Shafts

Ref.No.	Description	Inlet Hose Size	List Price	Code
Udor 840700	Kappa 33 GR (32.6 LPM)	1"	\$ 735.00 +GST	C
Udor 841200	Kappa 43 GR (45.7 LPM)	1 1/4"	\$ 785.00 +GST	C
Udor 841700	Kappa 53 GR (54.8 LPM)	1 1/4"	\$ 835.00 +GST	C
Udor 813900	Delta 75 VA (76.0 LPM)	1 1/4"	\$ 1,180.00 +GST	C
Udor 845000	Zeta 120 VA (116 LPM)	1 1/2"	\$ 1,490.00 +GST	C

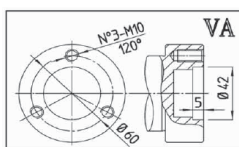
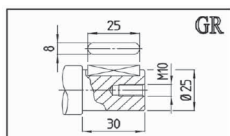

Ref.No.	Description	List Price	Code
Udor 417700	Hydraulic Connection Kit (Kappa 33/43/53 GR)	\$ 135.00 +GST	C
Udor 415400	Hydraulic Connection Kit (Delta 75/100 VA)	\$ 145.00 +GST	C
Udor 418700	Hydraulic Connection Kit (Zeta 120 1C)	\$ 225.00 +GST	C
Udor 417300	Hydraulic Connection Kit (Zeta 170-260 1C)	\$ 225.00 +GST	C



(Kits are to fit the Danfoss Hydraulic motors with a 25mm Shaft)



Braglia PA Pump

Hydraulic Drive Fitting Pump

Ref.No.	Description	List Price	Code
B600.1315.2	2" PAH50 Pump with Hydraulic Motor (25m Max Head / 620 LPM Flow)	\$ 2,610 +GST	C

Udor Electric Pump Units



Low Pressure Pumps (290psi) with Plug and switch

Ref.No.	Description	Inlet Hose Size	List Price	Code
Udor 234700	Iota 20 Pump with 230v Motor (19 LPM) (Single Outlet Control Unit)	3/4"	\$ 1,120 +GST	C

High Pressure Pumps (580psi) No Plug or Switch

Ref.No.	Description	Inlet Hose Size	List Price	Code
Udor 231900	Kappa 25 Pump with 230v Motor (29.5 LPM) (DL 2 Tap Control Unit)	1"	\$ 1,750 +GST	C
Udor 496900	Kappa 33 Pump with 230v Motor (32.6 LPM) (DL 2 Tap Control unit)	1"	\$ 2,000 +GST	C
Udor 491900	Kappa 65 Pump with 380v Motor (65 LPM) (DL 2 Tap Control unit)	1 1/4"	\$ 2,850 +GST	C



Udor Beta Series Diaphragm Pumps

UDOR BETA Series Pumps Have Brass Heads, Stainless Steel And Brass Manifolds, Steel Connecting Rods, Mounting Rails And A Dual 1-3/8" Six Spline Male Shaft.

High Pressure Pumps (725psi)

Ref.No.	Description	Inlet Hose Size	Outlet Hose Size	List Price	Code
Udor 820200	Beta 110 2C (128 LPM)	1 1/4"	3/4"	\$ 2,535 +GST	C
Udor 822200	Beta 150 2C (170 LPM)	1 1/2"	3/4"	\$ 3,355 +GST	C



Taral Pumps and Parts

Taral Pumps

Ref.No.	Type	List Price
TAR 3500137	Taral 30 Pump (1 3/8" Shaft)	\$ 495.00
TAR 3900173	Taral 60 Pump (1 3/8" Shaft)	\$ 895.00
TAR 3900176	Taral 60 Pump (As Fitted to Fan units)	\$ 1,025.00



Taral Pump Parts

Ref.No.	Type	List Price
TAR 3501004	Diaphragm TAR-30/60	\$ 18.00
TAR 1901007	Diaphragm TAR-50	\$ 19.55
TAR 1902015	Suction Diaphragm TAR-50	\$ 14.00
TAR 2902004	Air Diaphragm TAR-30	\$ 37.50
TAR 1902002	Air Diaphragm TAR-50	\$ 29.50
TAR 1901027	Valve TAR-50	\$ 10.00
TAR 1901004	O Ring For Valve TAR-50	\$ 3.50
TAR 3501018	Valve TAR-30/60	\$ 18.50
TAR 3501013	O Ring For Valve TAR-30	\$ 3.50
TAR 0106228	O Ring For Valve TAR-60	\$ 3.50

Udor Pump Repair Kit

Iota Pump Parts

Ref.No.	Type	Kit No.	List Price
UDOR 606237	Diaphragm Kit	536	\$ 44.75
UDOR 606238	Valve Kit	537	\$ 72.50
UDOR 606240	Bolt and Disc Kit	539	\$ 22.90

Kappa Pump Parts (25/32)

Ref.No.	Type	Kit No.	List Price
UDOR 6062B5	Diaphragm Kit 25,32	613	\$ 59.40
UDOR 606242	Valve Kit	541	\$ 90.00
UDOR 6062B4	Bolt and Disc Kit	612	\$ 40.70

Kappa Pump Parts (33/43/53/55/65/75)

Ref.No.	Type	Kit No.	List Price
UDOR 6062A2	Diaphragm Kit 33,43,53	601	\$ 76.60
UDOR 870026	Diaphragm Kit 55,65	624	\$ 90.50
UDOR 606205	Diaphragm Kit 75	504	\$ 99.50
UDOR 606246	Valve Kit	545	\$ 132.70
UDOR 606248	Bolt and Disc Kit	547	\$ 59.40

Zeta Pump Parts (40/70/120/170/260)

Ref.No.	Type	Kit No.	List Price
UDOR 6062B8	Diaphragm Kit 70	616	\$ 72.60
UDOR 606297	Diaphragm Kit 40-P,85-P	597	\$ 121.95
UDOR 606289	Diaphragm Kit 120	589	\$ 147.20
UDOR 870009	Diaphragm Kit 170	626	\$ 196.00
UDOR 606292	Diaphragm Kit 260	592	\$ 256.50
UDOR 6062D8	Valve Kit 70, 40-P,85-P	641	\$ 162.00
UDOR 6062D7	Valve Kit 120	640	\$ 220.00
UDOR 6062D5	Valve Kit 170	638	\$ 295.00
UDOR 6062D3	Valve Kit 260	636	\$ 445.00

Beta Pump Parts (110/150)

Ref.No.	Type	Kit No.	List Price
UDOR 606257	Diaphragm Kit 110	556	\$ 130.50
UDOR 606233	Diaphragm Kit 150	532	\$ 143.50
UDOR 6062D9	Valve Kit 110	642	\$ 205.00
UDOR 6062E1	Valve Kit 150	643	\$ 275.00



Control Unit Parts

Ref.No.	Type	Kit No.	List Price
UDOR 606253	DS Repair Kit (SS Seat)	552	\$ 63.70
UDOR 606255	DS Repair Kit	554	\$ 59.50
UDOR 6062A9	DL Repair Kit	608	\$ 47.75

Oil Sight Glass For Gearbox

Ref.No.	Type	List Price
UDOR 160369	1/4" Sight Glass	\$ 11.50
UDOR 160333	3/8" Sight Glass	\$ 15.00

Oil Reserve Assy

Ref.No.	Type	List Price
UDOR 603308	Oil Reserve for Kappa 33/43/53/75	\$ 62.30
UDOR 603302	Oil Reserve for Zeta 230/260	\$ 89.15
UDOR 603303	Oil Reserve for KA150 / Beta 150	\$ 89.50

Viton Diaphragms

Ref.No.	Type	List Price
UDOR 090317	Viton Air Diaphragms for Iota-20	\$ 110.00
UDOR 090318	Viton Diaphragms for Iota-20	\$ 115.00
UDOR 090358	Viton Diaphragms for 33/43/53	\$ 82.00

Udor Pump Units

The Udor Iota-20 is a two diaphragm pump with pulsation dampener and control unit with adjustable pressure regulator, manual dump lever and pressure gauge.

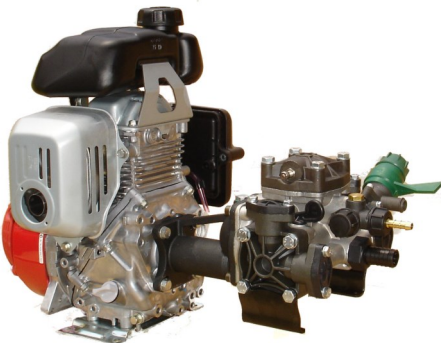

Iota 20 Pump (290psi / 19 LPM)

Ref.No.	Motor Type	Frame	List Price	Code
KA19-3H	3hp Honda GX100	No	\$ 1,770.00	C
KA19-3HF	3hp Honda GX100	Yes	\$ 1920.00	C
KA19-3T	3hp Teng long 152F	No	\$ 1,070.00	C
KA19-3TF	3hp Teng long 152F	Yes	\$ 1,220.00	C
KA19-5H	5hp Honda GC160	No	\$ 1,440.00	C
KA19-5HF	5hp Honda GC160	Yes	\$ 1,590.00	C

Udor Pump Units

The Udor Kappa 25 is a two diaphragm pump with pulsation dampener and control unit with adjustable pressure regulator, manual dump lever and pressure gauge.

Kappa 25 Pump (435psi / 29.5 LPM)				
Ref.No.	Motor Type	Frame	List Price	Code
KA25-3H	3hp Honda GX100	No	\$ 1,990.00	C
KA25-3HF	3hp Honda GX100	Yes	\$ 2,140.00	C
KA25-3T	3hp Teng long 152F	No	\$ 1,290.00	C
KA25-3TF	3hp Teng long 152F	Yes	\$ 1,440.00	C
KA25-5H	5hp Honda GC160	No	\$ 1,660.00	C
KA25-5HF	5Hp Honda GC160	Yes	\$ 1,810.00	C
KA25-5.5H	5.5hp Honda GX160	No	\$ 1,735.00	C
KA25-5.5HF	5.5hp Honda GX160	Yes	\$ 1,885.00	C



Kappa Pumps

This package includes a Udor Kappa Diaphragm Pump, Gearbox, 2 Tap Control Unit fitted to a Honda GC or GX Engine.

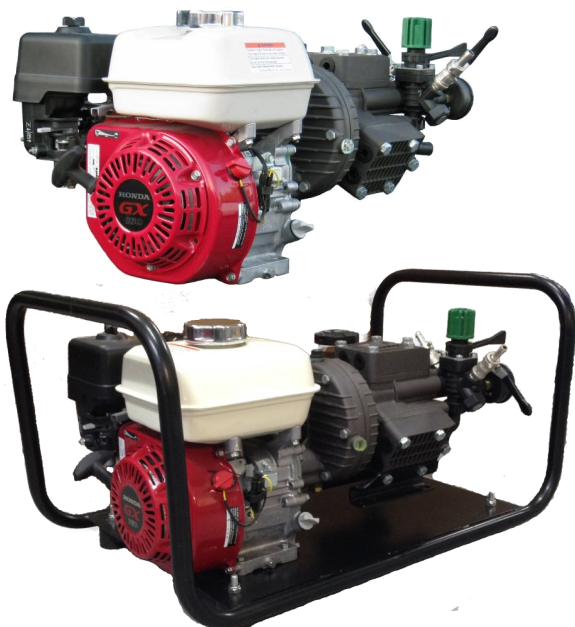

Kappa Pumps (580psi)					
Ref.No.	Motor Type	Frame	Flow	List Price	Code
KA33-5H	5hp Honda GC160	No	32.6	\$ 1,920.00	C
KA33-5HF	5hp Honda GC160	Yes	32.6	\$ 1,995.00	C
KA33-5.5H	5.5hp Honda GX160	No	32.6	\$ 1,995.00	C
KA33-5.5HF	5.5hp Honda GX160	Yes	32.6	\$ 2,215.00	C
KA43-5.5H	5.5hp Honda GX160	No	45.7	\$ 2,045.00	C
KA43-5.5HF	5.5Hp Honda GX160	Yes	45.7	\$ 2,265.00	C
KA53-5.5H	5.5hp Honda GX160	No	54.8	\$ 2,095.00	C
KA53-5.5HF	5.5hp Honda GX160	Yes	54.8	\$ 2,315.00	C
KA53-6.5H	6.5hp Honda GX200	No	54.8	\$ 2,220.00	C
KA53-6.5HF	6.5hp Honda GX200	Yes	54.8	\$ 2,440.00	C
KA75-9H	9hp Honda GX270	No	76	\$ 3,580.00	C
KA75-9HF	9hp Honda GX270	Yes	76	\$ 3,800.00	C
KA75-9H-ES	9hp Honda GX270 E/S	No	76	\$ 4,030.00	C
KA75-9HF-ES	9hp Honda GX270 E/S	Yes	76	\$ 4,250.00	C

Zeta Pumps

This package includes a Udor Zeta Diaphragm Pump, Gearbox and fitted to a Honda Gas Engine.

Zeta-P 40 Pump Comes with a 2 Tap DL Control unit

Zeta 120 Pump Sold with out Control unit

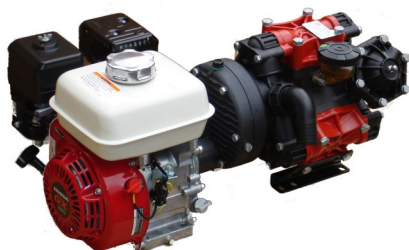

Zeta Pumps (290psi)					
Ref.No.	Motor Type	Frame	Flow	List Price	Code
Zeta-P 40-5H	5hp Honda GC160	No	44	\$ 2,310.00	C
Zeta-P 40-5HF	5hp Honda GC160	Yes	44	\$ 2,530.00	C
Zeta-P 40-5.5H	5.5hp Honda GX160	No	44	\$ 2,385.00	C
Zeta-P 40-5.5HF	5.5hp Honda GX160	Yes	44	\$ 2,605.00	C
Zeta 120-6.5H	6.5hp Honda GX200	No	116	\$ 2,805.00	C
Zeta 120-6.5HF	6.5Hp Honda GX200	Yes	116	\$ 3,025.00	C
Zeta 120-6.5H-ES	6.5hp Honda GX200 E/S	No	116	\$ 3,355.00	C
Zeta 120-6.5HF-ES	6.5hp Honda Gx200 E/S	Yes	116	\$ 3,575.00	C

Prices shown are current at time of publication and may be subject to change.

3 George Terrace, Onehunga , Auckland

Phone 09 634 4632 Fax 09 634 4238

Email Sales@Agripower.co.nz

Agripower LTD